

Standing Table on Wheels

Assembly instructions



studio
tools

Scope of delivery

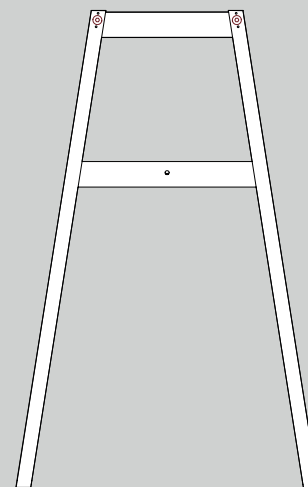

A Base frame (2x)



B Top cross struts (2x)



C Middle cross strut (1x)

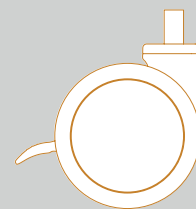

D Castors with brakes (4x)

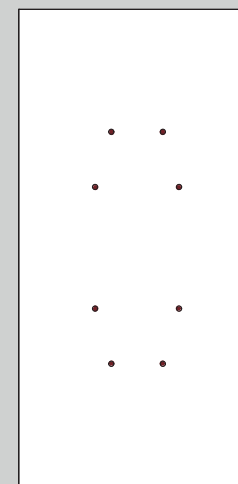

E Tabletop large (1x)



F Tabletop small (1x)

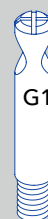

G1, G2 & G3 Quick Connectors (6x)



G3



H Countersunk screws (14x)

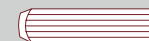



I1 Dowel thick (2 x | 8x30)



I2 Dowel thin (8 x | 6x30)

I Assembly of table base

| | |
|---|---|
| 2x A Base frame | 6x G1  |
| 2x I1  | 8x I2  |

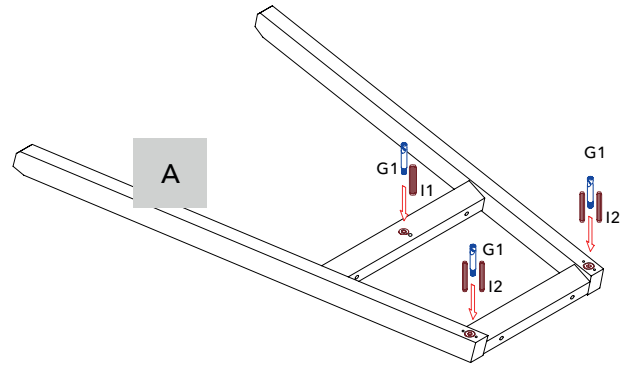

| | |
|--|---|
| 2x B Top cross struts 1x C Middle cross strut | 6x G2  |
|--|---|

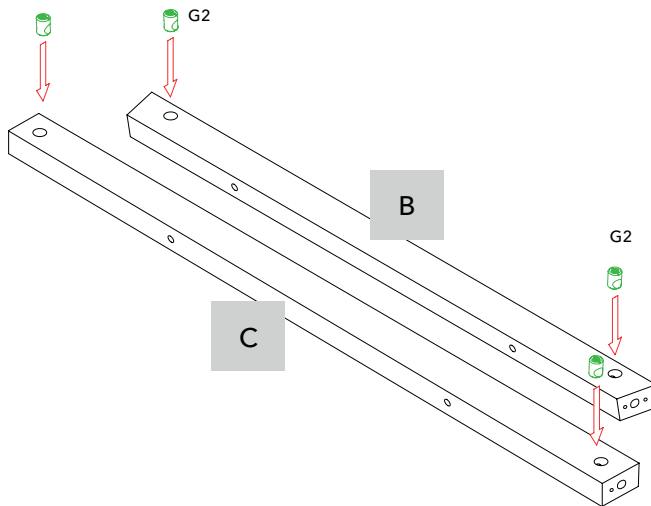

| |
|----------------------------|
| A + B + C |
| * See Quick Connector tips |

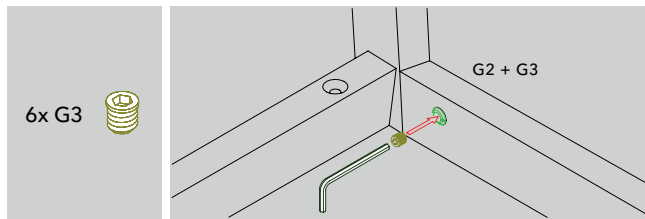
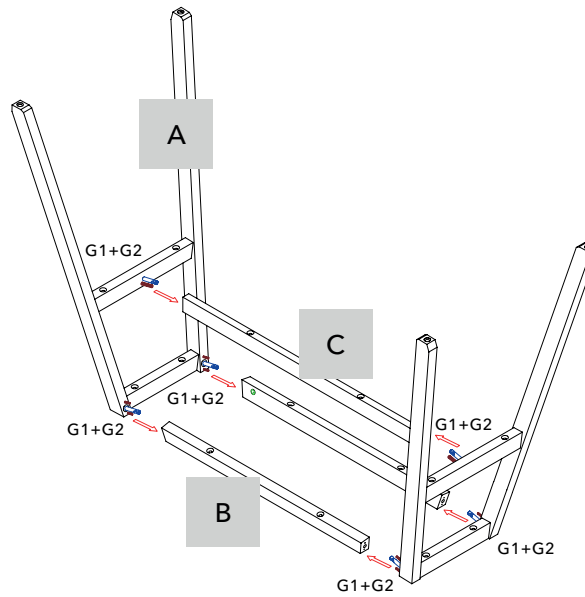

| |
|------------------------|
| * Quick Connector tips |
|------------------------|

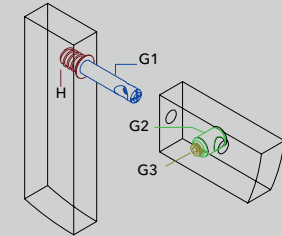



Screw the steel dowel (G1) into the preassembled steel socket (H) as far as it will go.

Push the housing (G2) into the hole in the wood. Make sure that the housing (G2) is positioned in such a way that the hole in the housing (G2) is correctly aligned and the two workpieces (G1 + G2) can be plugged together.

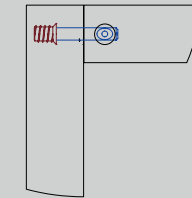
Screw the grub screw (G3) into the housing (G2).



-  Optimum positioning of the steel dowel (G1).
-  Incorrect positioning. Loosen steel dowel (G1) until the holes are aligned. The steel dowel (G1) does not have to be tightly screwed into the preassembled steel socket (H), it can be loosened by up to a half rotation.

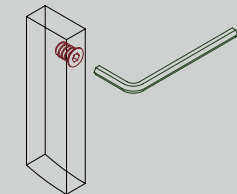

If for any reason the positioning of the steel dowel (G1) is still incorrect or too loose, the preassembled steel socket (H) can be loosened or tightened accordingly.

! To prevent damage, assemble the object on a soft surface.

II Screw castors to table base

4x D

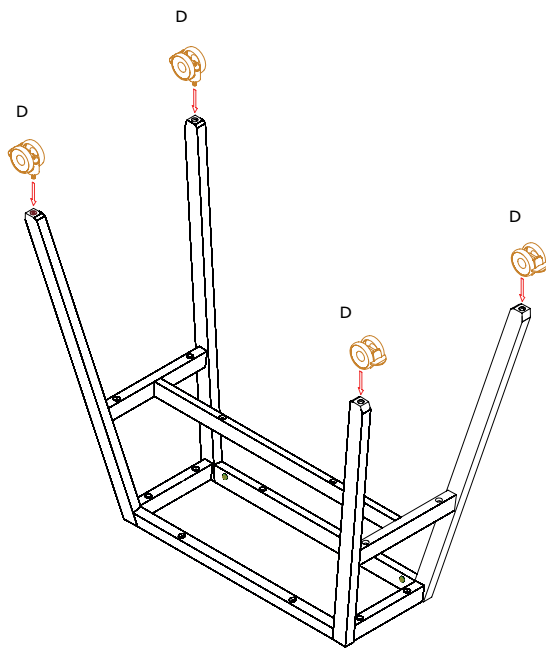

III Attach tabletop large to table base

1x E Tabletop large

8x H

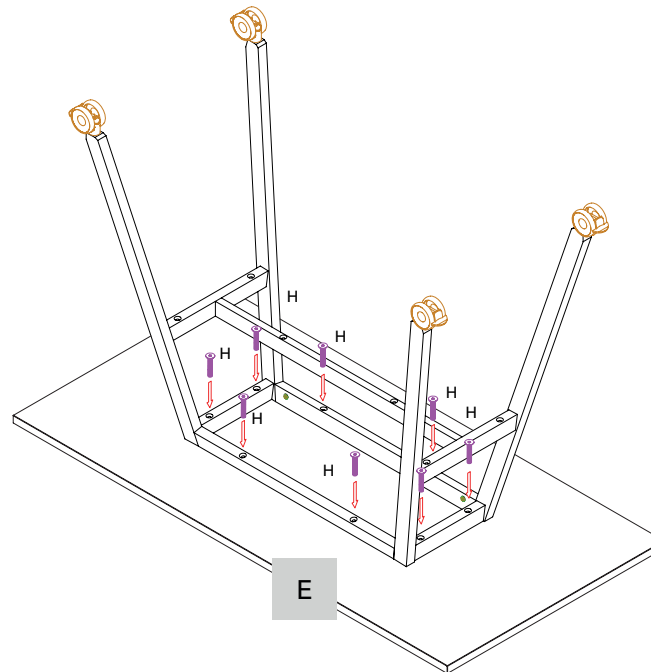

IV Attach tabletop small to table base

1x F Tabletop small

6x H

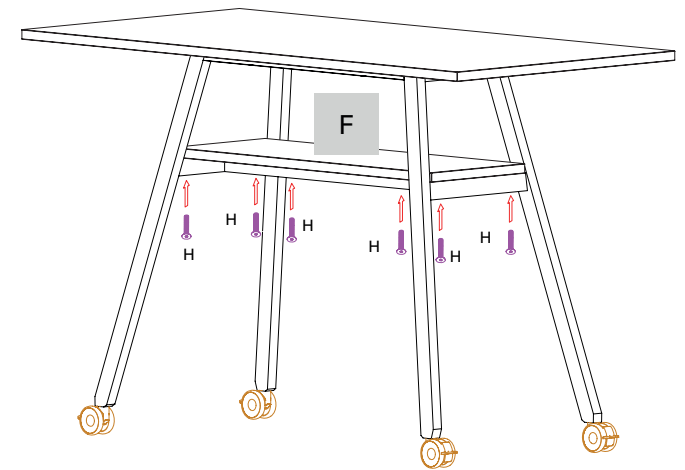
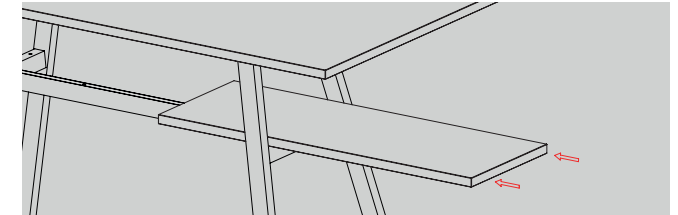

To prevent damage, assemble the object on a soft surface.